

FORD TRANSIT CEILING LINER (2015+)

130" LR | 148" LR

INSTALLATION INSTRUCTIONS

RECOMMENDED TOOLS

8mm nut driver/wrench

Flathead Screwdriver

Jigsaw/shears

BEFORE BEGINNING THE INSTALLATION

1. Refer to the images below and the table on page 2. Check to make sure all of the listed items were provided.
2. Gather the recommended tools listed above.

NOTES:

- Install the ceiling liners in van with the carpet side facing floor.
- When assembling with a VanGuard Wall Panel Kit, install the wall panels prior to installing the ceiling liner.
- If your van has extra ceiling lights, refer to the additional step on page 7 before installation.

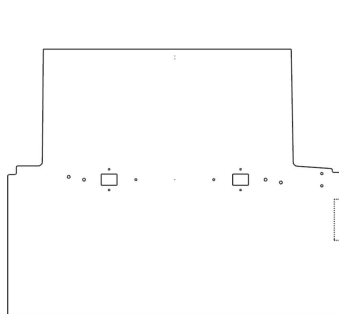

Front Panel

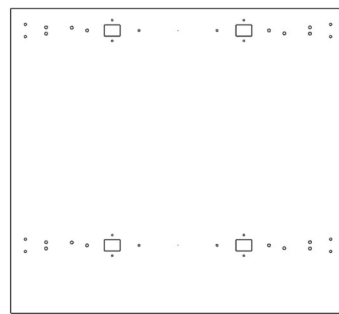

Rear Panel

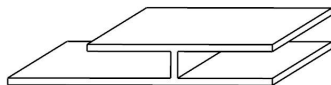

H Channel

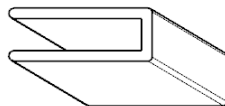

U Channel

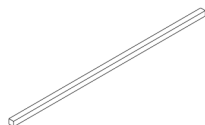

420040 - 41" Foam/
Adhesive

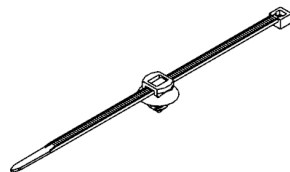

630195 - Cable Tie and Fir Tree



630162 - Trim Pin



380354 - Trim Pin, Small

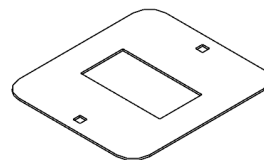

570479A - Light Mounting Plate

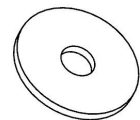

380248 - Washer

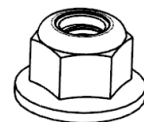

380356 - Flanged Nut



380484 - Carriage Bolt



PA0619 - Adhesive Promoter

Use this table to verify all components are in the kit for your vehicle.

Regular WB (130"), Low Roof Cargo Van		
Part Number	Description	Quantity
650001	FRONT PANEL	1
650002	REAR PANEL	1
630194	H CHANNEL, 58.875"	1
630193	U CHANNEL, 45"	1
630188	U CHANNEL, 40.5"	4
380248	WASHER	4
380356	FLANGED NUT	4
380358	CARRAIGE BOLT	4
380354	TRIM PIN, SMALL	10
570479A	LIGHT MOUNTING PLATE	2
630162	TRIM PIN	26
630195	CABLE TIE AND FIR TREE	3
420040	41" FOAM/ADHESIVE	1
PA0619	ADHESIVE PROMOTER	1

Long WB (148"), Low Roof Cargo Van		
Part Number	Description	Quantity
650001	FRONT PANEL	1
650006	REAR PANEL	1
630194	H CHANNEL, 58.875"	1
630193	U CHANNEL, 45"	1
630191	U CHANNEL, 49.44"	4
380248	WASHER	4
380356	FLANGED NUT	4
380358	CARRAIGE BOLT	4
380354	TRIM PIN, SMALL	14
570479A	LIGHT MOUNTING PLATE	2
630162	TRIM PIN	36
630195	CABLE TIE AND FIR TREE	3
420040	41" FOAM/ADHESIVE	1
PA0619	ADHESIVE PROMOTER	1

- 1 Install light mounting plate to the ceiling liner on the carpeted side of the liner.

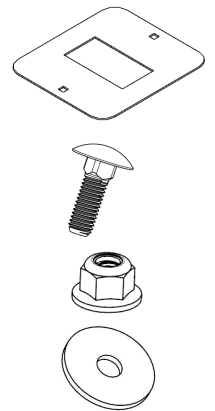
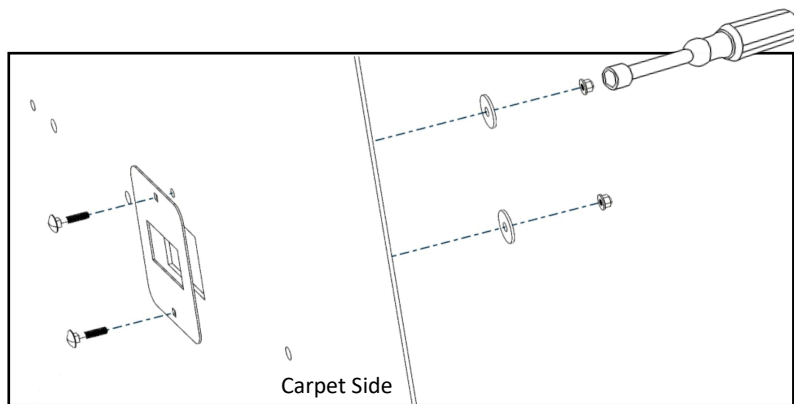

- 2 Remove ceiling lights from van.

Disconnect wires from back of light and set light aside for later use.

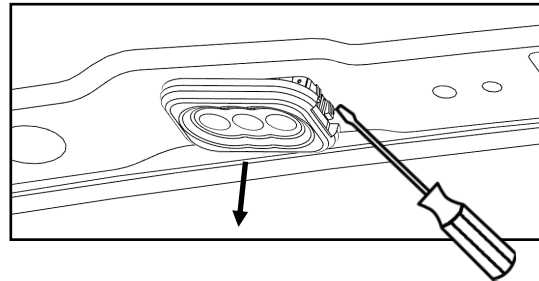

- 3 If your van is equipped with a single sliding side door, skip this step. If your van is equipped with dual swing-open side doors, cut out and discard the perforated area on the side of the front panel.

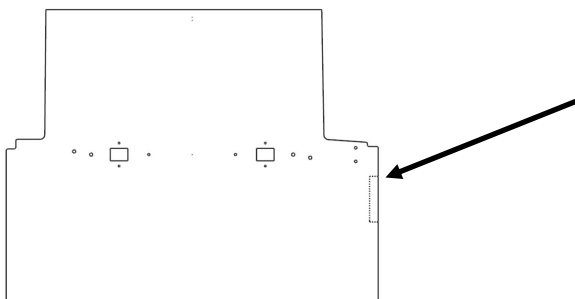

4

Apply adhesive promoter on one leg of the odd sized U channel, allow to dry (typically 2 minutes). Do not discard the remaining adhesive promoter. Peel the backing from one side of the 41" Foam/Adhesive piece. Center and adhere it to the prepared side of the U channel. Apply pressure to foam for 30 seconds. Trim foam that overhangs the ends of the U channel.

Adhesive promoter area

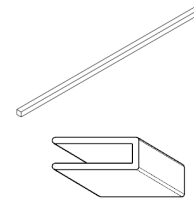
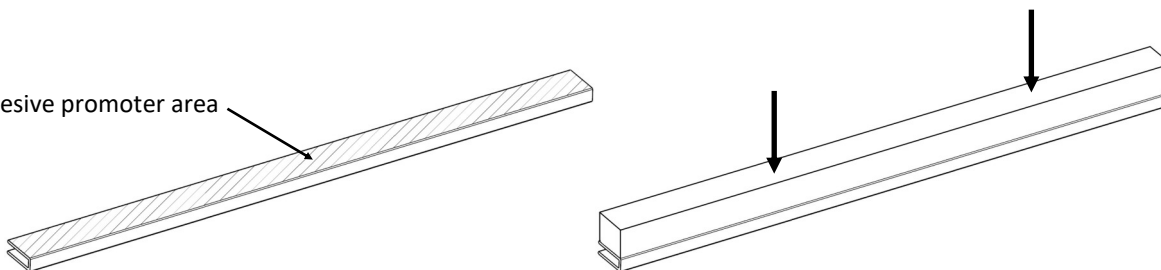

5

Install the U channel and foam to the front edge of the front panel.

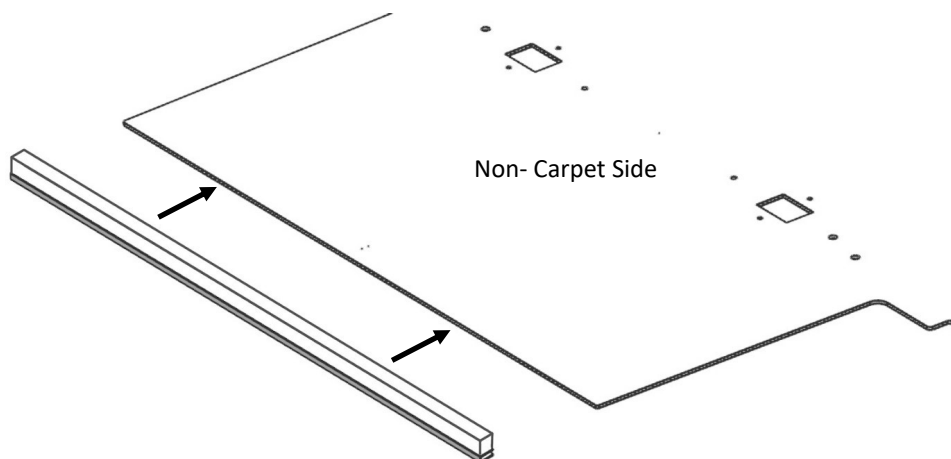

6

Cut the zip ties in these three locations and remove the push fastener from the hole, discard it.

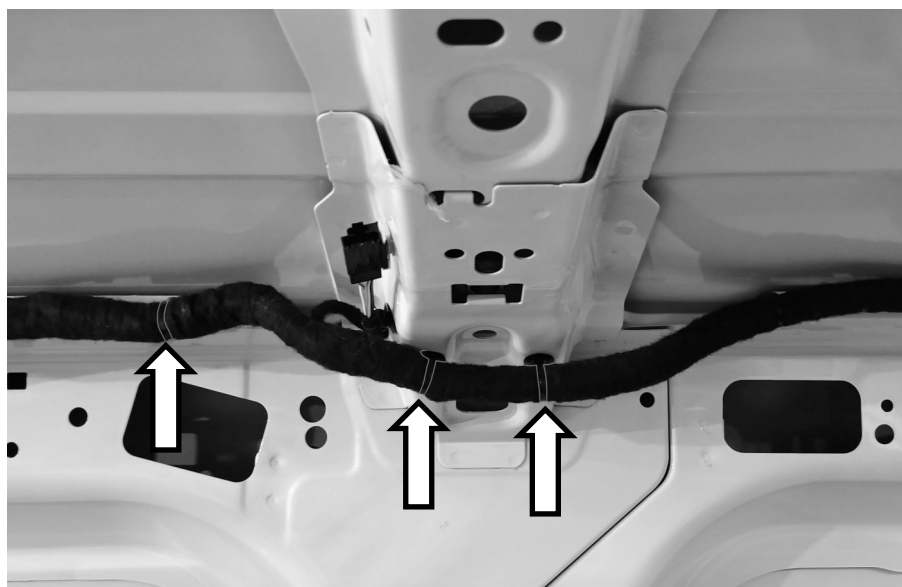

7

Install rear ceiling liner panel in vehicle, carpet side towards floor. Align hole rows with ceiling support beams.

- Install trim pins in the holes marked below, starting with the holes closest to the center of the panel.

Note: Do not install fasteners in outer-most holes. Rear panels of some kits may include an additional row of holes than shown below. These kits include additional trim pins to be installed.

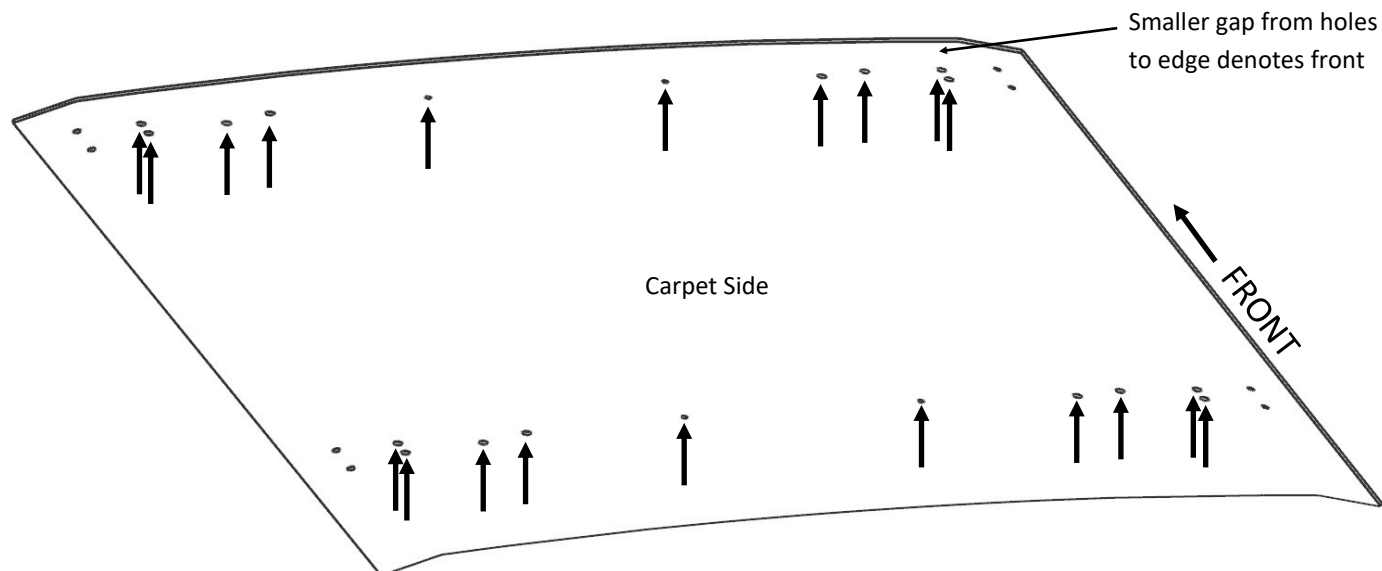

8

Install H channel on front edge of rear panel. Longest leg of H channel should be top and facing away from rear panel. Slide front panel rear edge into H channel.

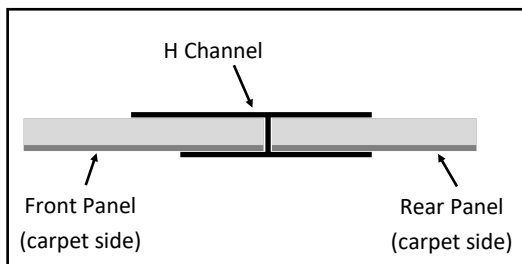
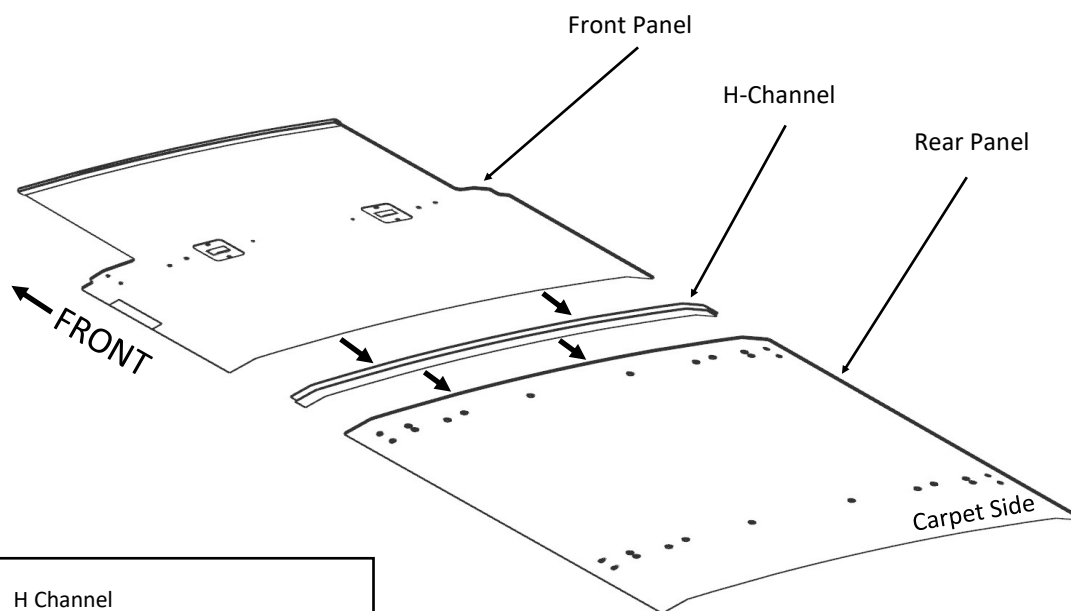
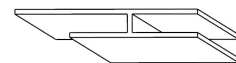

9

Install fasteners in Front Panel

- Install trim pins in the holes marked below, starting with the holes closest to the center of the panel.

Note: Do not install fasteners in outer-most holes

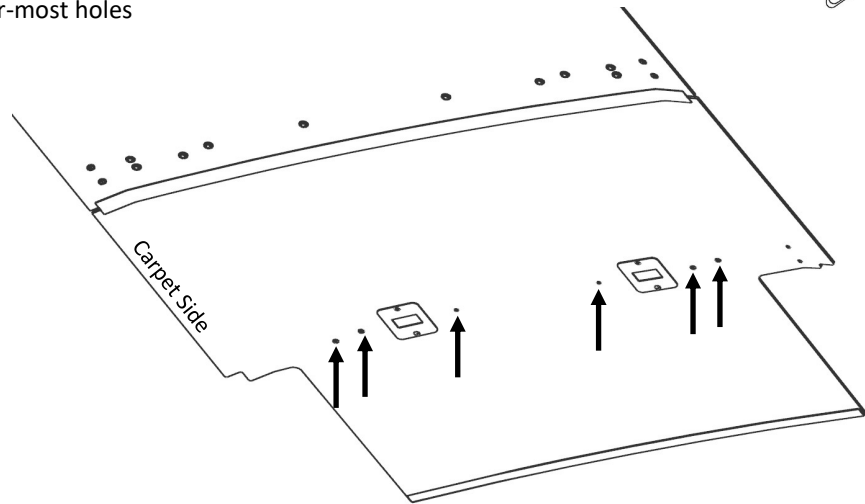

10

Pull ceiling light cables through light mounting plate. Reattach cables to light and install light into light mounting plate.

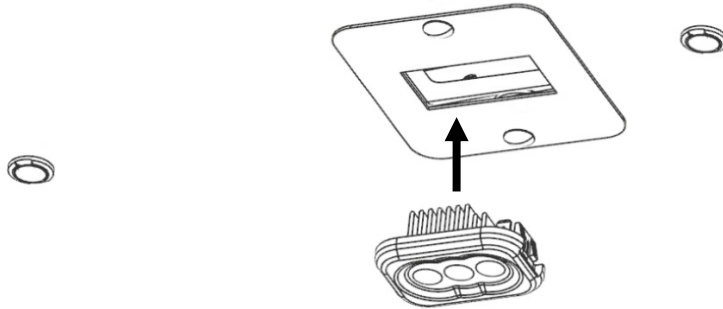

11

Install the four U channels of the same length to the side of the ceiling liner panels. Start with rear channels and align to rear edge of rear ceiling liner panel.

Note: If your van is equipped with dual swing-open side doors, you will need to cut the U Channel to fit the cut out you made in step #3.

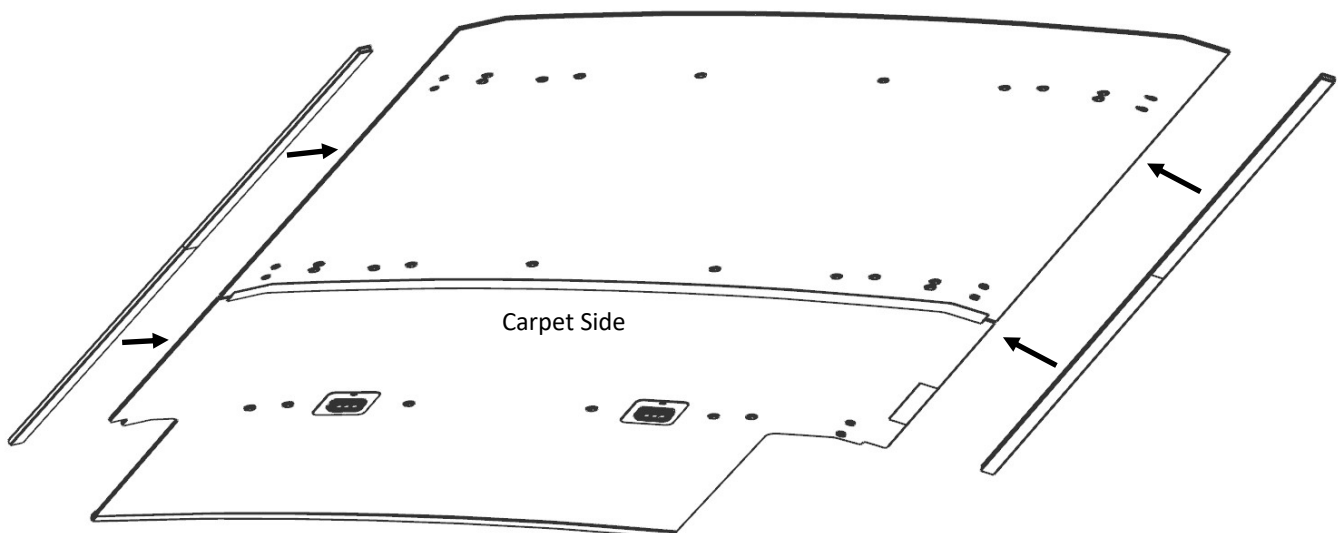
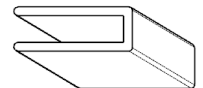

- 12 Insert smaller trim pin in the outer-most holes.

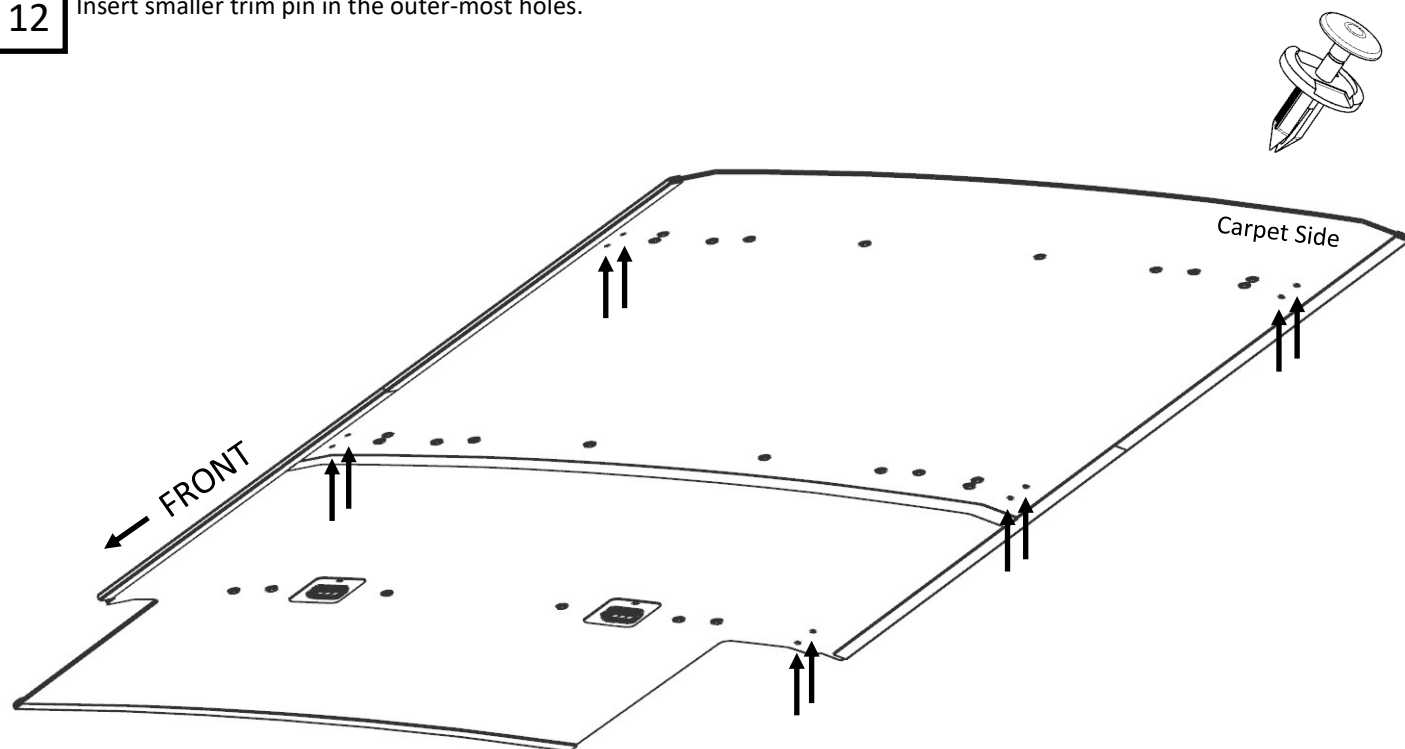

- 13 Use cable tie and fir tree provided to secure the cable that was cut in [step 6](#). You may use existing holes or drill new holes with a 1/4" drill bit.

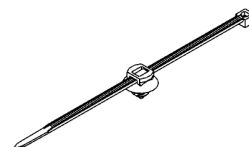

- 14 Pull down and hold the front edge of front panel away from the ceiling. Apply adhesive promoter on the ceiling where the Foam/Adhesive piece will adhere. Allow promoter to dry (typically 2 minutes). Peel the remaining backing from the Foam/Adhesive piece. Place the liner back into position and press to the ceiling. Apply pressure to the ceiling liner for 30 seconds to ensure good adhesion.

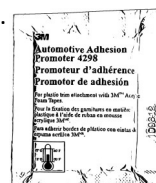
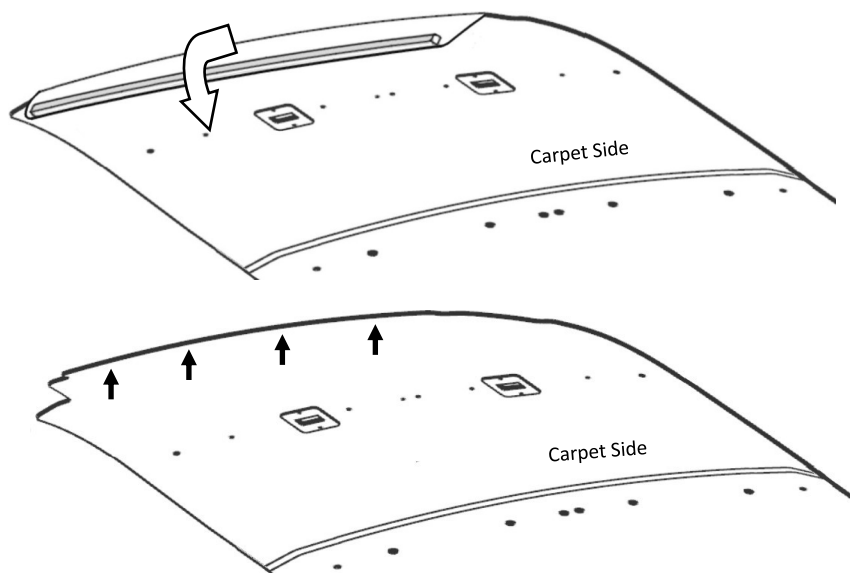

Additional step for installing ceiling liner in vans with extra ceiling lights.

Tools Needed

Jigsaw or sharp knife - Drill with 7mm or 1/4" drill bit

Transit vans come with lights pre-installed in the ceiling support beams that align with row #1 in the image. If the vehicle has additional lights installed at other rows, follow these steps before installation. You will also need an additional hardware kit (PA01307) that includes one extra set of light mounting plates.

A1. Cut out the rectangular holes in the row with the extra lights (2 of each per row). These are perforated in the back of the liner for easy cutting.

A2. Bolt holes are marked with a small dimple. Drill (or cut) these out for the light mounting plate hardware.

A3. Install additional light mounting plates according to step #1 at the beginning of the instruction sheet.

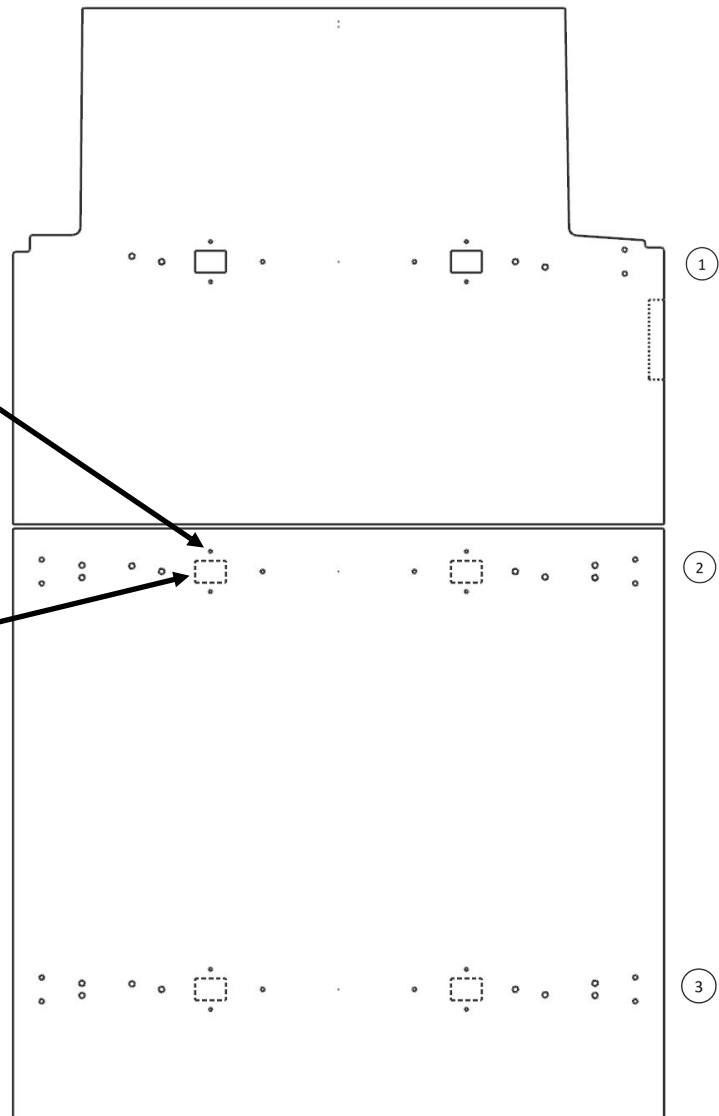

VANGUARD
PROTECTION PERFECTION

800.356.7704 - www.Penda.com

Thank you for purchasing a genuine Penda VanGuard™ product. This product has been designed and validated to fit your vehicle and provide the best possible solution. Please check our other products online or at your distributor.